

vtech[®]

User's Manual

abc Text & Go Motion



© 2012 VTech
Printed in China
91-001633-007 UK

VTech understands that a child's needs and abilities change as they grow and with that in mind we develop our toys to teach and entertain at just the right level...

vtech Baby

Toys that will stimulate their interest in different textures, sounds and colours

I am...

...responding to colours, sounds and textures

...understanding cause and effect

...learning to touch, reach, grasp, sit-up, crawl and toddle

Birth-36 months



Pre-School

Interactive toys to develop their imagination and encourage language development

I want...

...to get ready for school by starting to learn the alphabet and counting

...my learning to be as fun, easy and exciting as can be

...to show my creativity with drawing and music so my whole brain develops

3-6 years



Electronic Learning Computers

Cool, aspirational and inspiring computers for curriculum related learning

I need...

...challenging activities that can keep pace with my growing mind

...intelligent technology that adapts to my level of learning

...National Curriculum based content to support what I'm learning at school

4-10 years



To learn more about this and other VTech® products, visit www.vtechuk.com

INTRODUCTION

Thank you for purchasing the **VTech® abc Text & Go Motion**. The **abc Text & Go Motion** combines preschool curriculum with a techy feel for a fun and engaging learning experience. Your child will love learning letters, words, numbers, logic and lots more. With vivid graphics, fun character friends, cool sound effects, and a motion sensor function, the **abc Text & Go Motion** provides a learning experience that's packed full of fun!



INCLUDED IN THIS PACKAGE

- One **VTech® abc Text & Go Motion**
- One instruction manual

WARNING: All packing materials, such as tape, plastic sheets, packaging locks and tags are not part of this toy, and should be discarded for your child's safety.

NOTE: Please keep the user's manual as it contains important information.

Unlock the packaging locks:

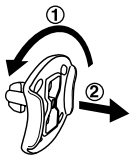

- ① Rotate the packaging locks 90 degrees counter-clockwise.
- ② Pull out the packaging locks.

GETTING STARTED

BATTERY INSTALLATION

1. Make sure the unit is OFF.
2. Locate the battery cover on the bottom of the unit. Use a coin or screwdriver to loosen the screw.
3. Install 3 new “AAA” batteries into the compartment as illustrated. (The use of new, alkaline batteries is recommended for maximum performance.)
4. Replace the battery cover and tighten the screw to secure.

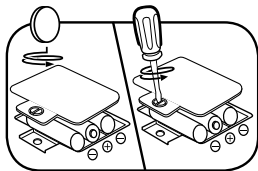

BATTERY NOTICE

- Use new alkaline batteries for maximum performance.
- Use only batteries of the same or equivalent type as recommended.
- Do not mix different types of batteries: alkaline, standard (carbon-zinc) or rechargeable (Ni-Cd, Ni-MH), or new and used batteries.
- Do not use damaged batteries.
- Insert batteries with the correct polarity.
- Do not short-circuit the battery terminals.
- Remove exhausted batteries from the toy.
- Remove batteries during long periods of non-use.
- Do not dispose of batteries in fire.
- Do not charge non-rechargeable batteries.
- Remove rechargeable batteries from the toy before charging (if removable).
- Rechargeable batteries are only to be charged under adult supervision.

Disposal of batteries and product



The crossed-out wheellie bin symbols on products and batteries, or on their respective packaging, indicates they must not be disposed of in domestic waste as they contain substances that can be damaging to the environment and human health.



The chemical symbols Hg, Cd or Pb, where marked, indicate that the battery contains more than the specified value of mercury (Hg), cadmium (Cd) or lead (Pb) set out in Battery Directive (2006/66/EC).

The solid bar indicates that the product was placed on the market after 13th August, 2005.

Help protect the environment by disposing of your product or batteries responsibly.

For more information, please visit:

www.recycle-more.co.uk

www.recyclenow.com

USING THE MOTION SENSOR

When playing motion based activities or using the motion sensor in the main menu, tilt the unit up at a slight angle (about 30 degrees) for best performance. Then tilt the unit left or right to use the motion action.

In the main menu and in the activities **Snowman Surprise and Creation Station**, you can tilt and hold the unit in one direction to get the same repeated motion action. In other activities, you must tilt the unit only once to get a response.



PRODUCT FEATURES

1. ON/OFF BUTTON

To turn the unit on, press the On/Off button. Press the On/Off button again to turn the unit off.

2. ACTIVITY BUTTONS



Press one of the Activity buttons to choose any of the 8 activities.

3. NUMBER BUTTONS



Press the number buttons to learn numbers or to answer number-related questions.

4. LETTER BUTTONS



Press the letter buttons to learn letters or to answer letter-related questions.

5. HELP BUTTON



Press this button to repeat the current question or instruction or get help in some activities.

6. LEFT AND RIGHT ARROW BUTTONS



Press these buttons to make your selections.

7. ENTER BUTTON

Press this button to confirm your choice.

8. SETTINGS BUTTON

Press this button to adjust the volume, screen contrast or turn the background music on/off.

There are 3 steps to adjust the volume and/or screen contrast.

1. Press the left or right arrow buttons to adjust the volume, then press Enter to confirm.
2. Next, press the left or right arrow buttons to adjust the screen contrast, then press Enter to confirm.
3. Finally, press the left or right arrow buttons to select Music On or Off, then press Enter to confirm.

9. AUTOMATIC SHUT-OFF

While playing games, the unit will automatically shut off when your batteries are low. A warning will be displayed on the screen as a reminder to change your batteries.

TO BEGIN PLAY

1. Press the **On/Off button** to turn the unit On.
2. The unit will play a short animation and then enter the activity menu. Tilt left or right or use the arrow keys to choose and then press the Enter button to confirm.
3. You can also press the individual activity buttons to select each activity directly.

ACTIVITIES:

The VTech® abc Text & Go Motion offers a total of 8 activities to play.

Activity 1 : Letter & Counting Fun

This activity teaches letters, vocabulary words, and counting. Press any letter button to hear the letter name and an associated vocabulary word. Press any number button to hear the number and count along with Kitty Cat.



Activity 2: Beginning Letters

This activity teaches the beginning letter of each word. A word and its corresponding picture will appear on the screen. Then the first letter will disappear and you must type in the missing letter.



Activity 3: More or Less

Perry Penguin is standing on a balance beam with some dots on each side. Listen to the question and then tilt the unit left or right or use the arrow buttons to pick the side that has the correct answer, then press Enter to confirm.



Activity 4: Snowman Surprise

Help Perry Penguin to make a snowman. A snowball is rolling on the screen with some objects on the road. Move the snowball to collect all the items (hat, scarf, eyes, nose, hands and so on) in order to make the snowman. Tilt the unit left and right or use the arrow keys to control the snowball.



Activity 5: Puppy Power

Help Peter Puppy to collect the bones and put them into the hole. Bones will fall from the top and Peter Puppy will catch them. Tilt the unit left or right or use the arrow buttons to drop the bone into the hole on the ground. Collect as many bones as you can before time's up!



Activity 6: Creation Station

Let's make our very own funny robot! Tilt the unit left or right or use the arrow buttons to choose the different body parts, and then press Enter to confirm.



Activity 7: Fun Time

Listen to the music with Peter Puppy, Millie Moo, Billy Bear, Kitty Cat, Ducky and Perry Penguin. Use the arrow buttons to choose from the 10 songs then some of the characters will dance to the music. Tilt the unit left or right to see some fun animations.



Activity 8: My Messages

Let's send and receive fun text messages! Press the My Messages button to receive a message. Then type in your own message and press the Enter or My Messages button to send a message back to your pal.



CARE & MAINTENANCE

1. Keep the unit clean by wiping it with a slightly damp cloth.
2. Keep the unit out of direct sunlight and away from any direct heat sources.
3. Remove the batteries when the unit is not in use for an extended period of time.
4. Do not drop the unit on a hard surface and do not expose the unit to excess moisture.

TROUBLESHOOTING

If for some reason the program/activity stops working, then please follow these steps:

1. Turn the unit OFF.
 2. Interrupt the power supply by removing the batteries.
 3. Let the unit stand for a few minutes, then replace the batteries.
 4. Turn the unit back ON. The unit will now be ready to play again.
 5. If the unit still does not work, replace with an entire set of new batteries.
- If the problem persists, please call our Consumer Services Department on 01235 546810 (from UK) or +44 1235 546810 (outside UK) and a service representative will be happy to help you.

IMPORTANT NOTE:

Creating and developing **VTech®** products is accompanied by a responsibility that we at **VTech®** take very seriously. We make every effort to ensure the accuracy of the information which forms the value of our products. However, errors sometimes can occur. It is important for you to know that we stand behind our products and encourage you to call our Consumer Services Department on 01235 546810 (from UK), or +44 1235 546810 (outside UK) with any problems and/or suggestions that you might have. A service representative will be happy to help you.

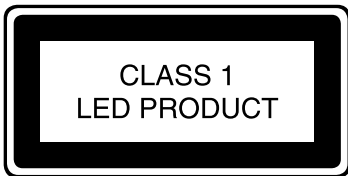



PRODUCT WARRANTY



Thank you for choosing this quality product from VTech. We hope it will bring many hours of entertainment, imaginative play and learning.

1. The product detailed above is covered by a one year warranty from the date of purchase, against any defects in materials or workmanship.
2. The product may be returned to the place of purchase. Alternatively the product can be returned to VTech Electronics Europe plc (see address below), with proof of purchase, without proof of purchase no replacement will be provided.
3. VTech Electronics Europe plc will examine the product and if it is found to be defective due to faulty materials or workmanship, will replace the product at their discretion.
4. If the product covered by this warranty is damaged due to misuse, modification or unauthorised repair, or because of faulty batteries, battery discharge or incorrect electrical connections, then this warranty becomes void.
5. This warranty is personal to the original purchaser and is not transferable.
6. Breakages to the LCD screen are not covered by the warranty.
7. Returns to VTech Electronics Europe plc should include a cheque or postal order for £1.50 towards the cost of return postage and packaging.
8. Products returned to VTech Electronics Europe plc, should be addressed as follows and packed carefully to avoid damage in transit (Please do not include batteries or adaptor).
Please include details of the fault together with your name and address.

VTech Electronics Europe plc, c/o Tablogix Limited, 200 Milton Park, Abingdon, Oxon OX14 4TA

THIS WARRANTY IS OFFERED AS AN EXTRA BENEFIT AND DOES NOT AFFECT CONSUMERS' STATUTORY RIGHTS.

This warranty is valid for the UK and Eire only. For products purchased outside the UK and Eire, please contact your local distributor or place of purchase.

